

FOR LEASE

Buildings 2 & 3

3367 Gun Club Road, Nazareth, PA 18064

OFFERING SUMMARY

Available SF: 11,600 SF (Total)

Lease Rate: \$6.50 - \$7.50 SF/yr
(NNN)

Lot Size: 10.97 Acres

Building Sizes: 9,600 SF
2,000 SF

Renovated: 2017

Zoning: General Industrial (I-2)

LOCATION OVERVIEW

1/4 mile south of Route 248 in Upper Nazareth Township

PROPERTY HIGHLIGHTS

- Four (4) Dock Doors
- Three (3) Over-sized Drive-In Doors
- Newly Installed Electric Service (400 Amp 480 Volt 3 Phase)
- T-5 Lighting
- Compressed Air Lines Throughout Building
- 400 Gallon Surge Tank (Supplied by Screw Compressor)
- 2+ Acres of Paved Trailer Parking/Outdoor Storage Available On-Site!

AVAILABLE SPACES

SPACE	LEASE RATE	SIZE
Building 3	\$12.00 SF/yr	9,600 SF

Amy Hawley, SIOR
Senior Advisor
484.245.1014
amy.hawley@svn.com

Michael Ciccone, Jr.
Associate Advisor
484.245.1034
michael.ciccone@svn.com

Tom Skeans, CCIM
Managing Director
484.245.1003
tom.skeans@svn.com



The information presented here is deemed to be accurate, but it has not been independently verified. We make no guarantee, warranty or representation. It is your responsibility to independently confirm accuracy and completeness. All SVN® offices are independently owned and operated.



Building 3 Photos

For Sale/Lease

Nazareth, PA 18064

Floor Plan

For Sale/Lease

Nazareth, PA 18064

Building 3

3367 Gun Club Rd
Nazareth, PA 18064



Ethan Medgie
Senior Advisor
ethan.medgie@svn.com
484-245-1015
610-248-7053

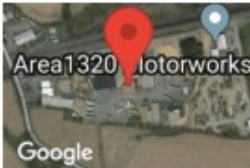

Statistics

9600 sq ft



Ground Floor

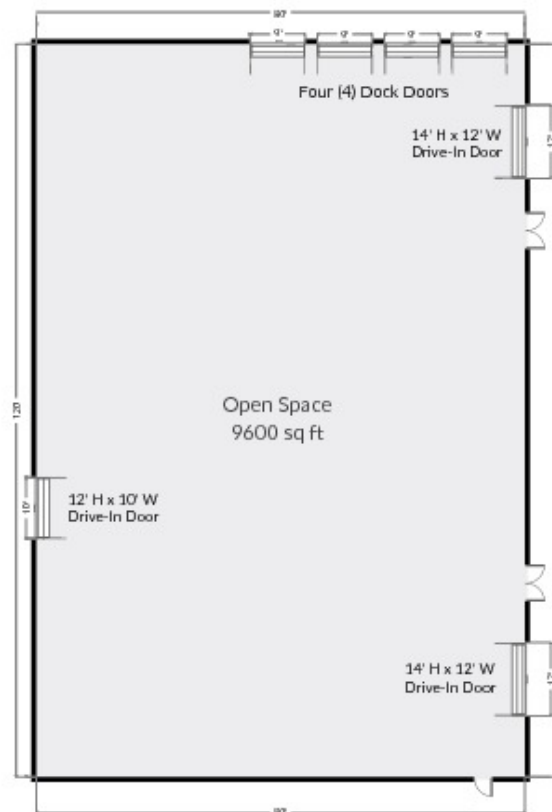

THIS FLOORPLAN IS PROVIDED WITHOUT WARRANTY OF ANY KIND. ALL INFORMATION, INCLUDING MEASUREMENTS USED, IS DEEMED RELIABLE BUT NOT GUARANTEED. PROPERTY OWNER DISCLAIMS ANY WARRANTY INCLUDING, WITHOUT LIMITATION, SATISFACTORY QUALITY OR ACCURACY OF DIMENSIONS.

0' 16' 32' 48' 1:263

Building 2 Photo & Site Aerials

For Sale/Lease

Nazareth, PA 18064



Floor Plan

For Sale/Lease

Nazareth, PA 18064



Building 2

3367 Gun Club Rd
Nazareth, PA 18064

Ethan Medgie
Senior Advisor
ethan.medgie@svn.com
484-245-1015 (office)
610-248-7053 (mobile)

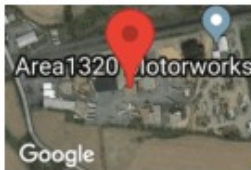

Statistics

2000 sq ft



Ground Floor

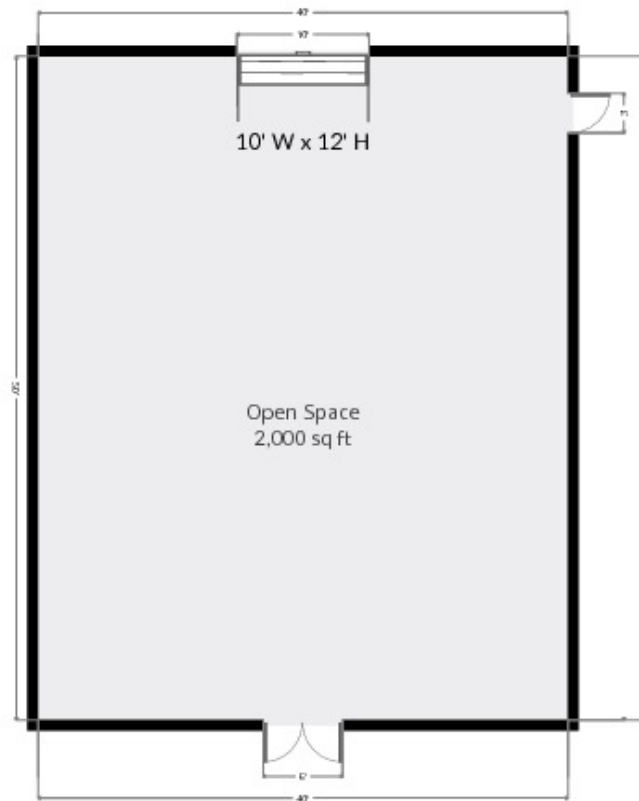

THIS FLOORPLAN IS PROVIDED WITHOUT WARRANTY OF ANY KIND. ALL INFORMATION, INCLUDING MEASUREMENTS USED, IS DEEMED RELIABLE BUT NOT GUARANTEED. PROPERTY OWNER DISCLAIMS ANY WARRANTY INCLUDING, WITHOUT LIMITATION, SATISFACTORY QUALITY OR ACCURACY OF DIMENSIONS.

0' 4' 8' 12' 16' 20' 1:121

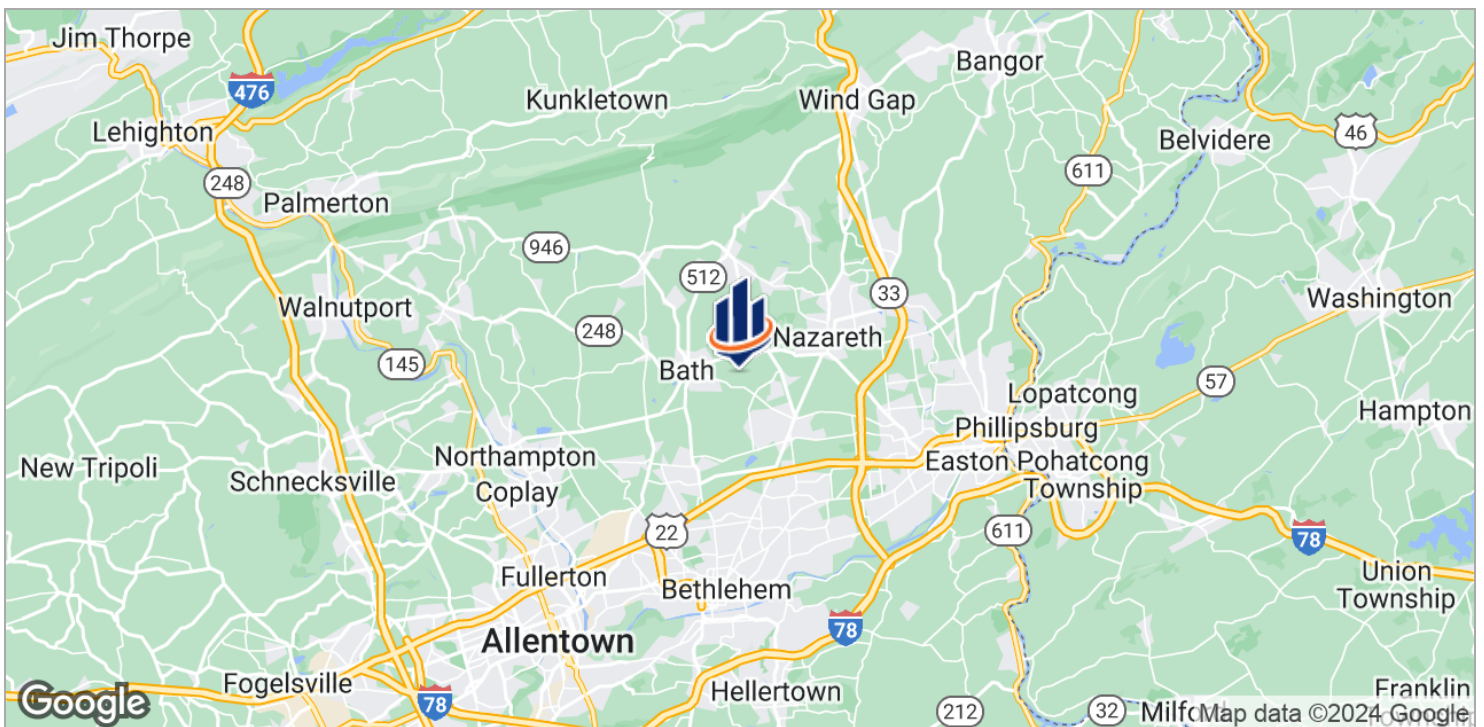

Amy Hawley, SIOR
Senior Advisor
484.245.1014
amy.hawley@svn.com

Michael Ciccone, Jr.
Associate Advisor
484.245.1034
michael.ciccone@svn.com

Tom Skeans, CCIM
Managing Director
484.245.1003
tom.skeans@svn.com



The information presented here is deemed to be accurate, but it has not been independently verified. We make no guarantee, warranty or representation. It is your responsibility to independently confirm accuracy and completeness. All SVN® offices are independently owned and operated.